



A2F Liquid Tight Straight Conduit Gland with Multi Hole Seal

Size : 16mm to 32mm & 3/8" to 1"
Function : Suitable for all types Liquid Tight Conduit.
Construction : Unlike normal conduit glands which have a two piece construction these conduit glands have a four piece construction and use an additional O-Ring to achieve IP66/IP67 protection levels.
 The additional components inside this gland are ferrule and clamping ring which in combination are able to provide an IP66/IP67 protection levels.

ATEX Certificate No. : Coming Soon
PESO Certificate No. : Coming Soon

Code of Protection : Ex db IIC Gb, Ex eb IIC Gb, Ex tb IIIC Db
Ingress Protection : IP66/IP67
Operating Temp. : -60°C to +135°C
Material : Nickle Plated Brass, Stainless Steel 316L
Thread : Metric, NPT
Seal Material : LSOH Silicone Seal, Nylon substrate
Features : Displacement Seal
Standard Accessories : IP Washer (Thread Seal)
Optional Accessories : Shroud, Lock Nut, Earth Tag, Serrated Washer, Ingress Disc

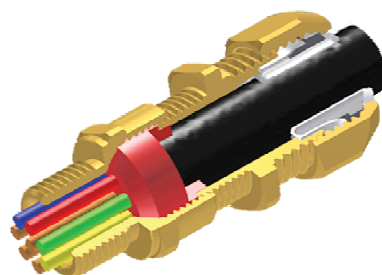
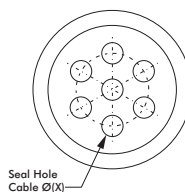
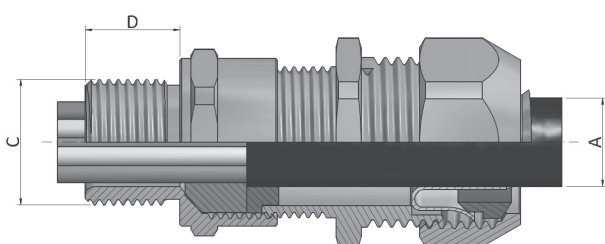

Gland Selection Chart

Size*	Standard Thread "C"		Op onal Thread		Thread Length "D"	Cable Dia. A		Mul Hole Seal Detail			Suitable for Conduit Size	Ordering Suffix for Conduit Size
	Metric	NPT	Metric	NPT		Min.	Max.	Seal Hole Cable Ø (X)	Number of Holes	Ordering Suffix for Seal		
16	16	3/8"	-	-	15.00	3.10	8.60	1.5	1 to 6	A	3/8"	MP10
	16	3/8"	-	-	15.00	3.10	8.60	2.0	1 to 6	B	3/8"	MP10
20	20	1/2"	25	3/4"	15.00	6.50	13.90	2.5	1 to 7	A	1/2"	MP15
	20	1/2"	25	3/4"	15.00	6.50	13.90	3.0	1 to 7	B	1/2"	MP15
	20	1/2"	25	3/4"	15.00	6.50	13.90	3.6	1 to 7	C	1/2"	MP15
	20	1/2"	25	3/4"	15.00	6.50	13.90	4.0	1 to 7	D	1/2"	MP15
25	25	3/4"	32	1"	15.00	11.30	19.90	2.5	1 to 7	A	3/4"	MP20
	25	3/4"	32	1"	15.00	11.30	19.90	3.0	1 to 7	B	3/4"	MP20
	25	3/4"	32	1"	15.00	11.30	19.90	3.6	1 to 7	C	3/4"	MP20
	25	3/4"	32	1"	15.00	11.30	19.90	4.0	1 to 7	D	3/4"	MP20
32	32	1"	40	1 1/4"	15.00	17.00	26.20	2.5	1 to 7	A	1"	MP25
	32	1"	40	1 1/4"	15.00	17.00	26.20	3.0	1 to 7	B	1"	MP25
	32	1"	40	1 1/4"	15.00	17.00	26.20	3.6	1 to 7	C	1"	MP25
	32	1"	40	1 1/4"	15.00	17.00	26.20	4.0	1 to 7	D	1"	MP25

Product Code for Ordering Purpose

Size	Type	Material	Thread Type	Shroud Type	Accessories	Conduit Size	Seal Type	Seal with Holes
20	A2FLTSMH	Brass-1	Standard Metric-11	PVC Shroud-PS	Lock Nut-5	MP10	A	Between 1 to 7. (Respectively According to Sizes*)
		Stainless Steel-2	Standard NPT-12	LSF Shroud-LS	IP Washer-6	MP15	B	
		Nickle Plated-3	Optional Metric-16	LSOH Shroud-SL	Serrated Washer-7	MP20	C	
			Optional NPT-17	PCP Shroud-PC	Ingress Disc-8	MP25	D	
					Earth Tag-9			

Ordering Information

Code: 20A2FLTSMH311PS569MP10A4
 A2FLTSMH-M20-MP10 Nickle Plated Liquid Tight Straight Conduit Gland Kit with seal included four holes of 2.5mm Dia.

20 = Gland Size, A2FLTSMH = Gland Type,
 3 = With Nickle Plated Brass Material
 11 = With Standard Metric Thread, PS = With PVC Shroud,
 5 = With Lock Nut, 6 = With IP Washer, 9 = With Earthing Tag,
 MP10 = Conduit Size, A = Ordering suffix for seal type, 4 = Number of Holes